



FAST, FLEXIBLE AND FULL SERVICE PUNCH SUPPLIER

ANCHOR DANLY manufactures a full line of standard and custom punch products, die buttons and retainers to high quality standards, giving you the reliability and dependable performance you expect. Punches have always been a significant product foundation of our business. Through the years, we have developed expertise in manufacturing a wide range of them.

Whatever your application may be, **PUNCHRITE** punches can fit your design. With our commitment to quality, price and delivery – whether standard or custom punch products – you can be confident that your order will ship as scheduled and arrive at your facility when you need it.



LET US QUOTE YOUR SPECIALS AS WELL

- Quick turnaround time
- The exact product you need
- Opportunity for innovation

PUNCH PERFORMANCE MEANS CONFIDENCE AND CONSISTENCY

- **Customer Service** – To answer your questions, solve your problems and expedite your orders.
- **Highest Quality Assurance** – ISO 9001:2000 registered certification.
- **Application & Technical Support** – Rely on our skilled and knowledgeable Engineering team for your punch product solutions.
- **More Sales Channels** – Territory managers are available for field support and product training with local distributors always ready to help.

QUOTE and ORDER FORM

 Quote

 Order Form

Customer Name: _____

Address: _____

City: _____ State: _____ Zip: _____

Phone: () _____ Fax: () _____ P.O.# _____

Today's Date: _____ Required Date: _____

CALL: 800-232-6592 or FAX: 800-432-6594

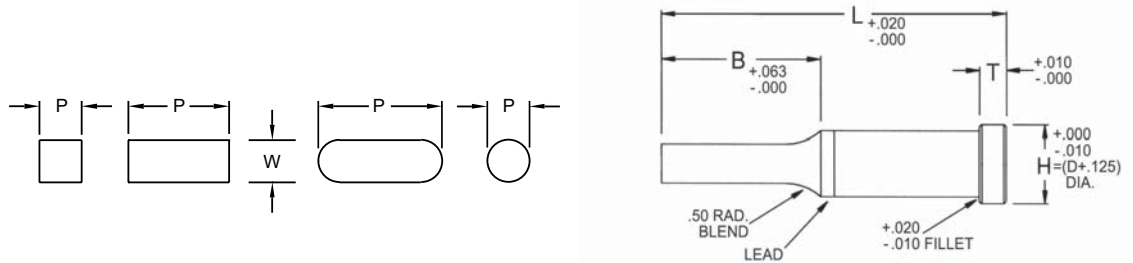

BASIC SERIES	QTY	D	L	B	P	W	H	T	MATL.	LOCKING DEVICE	LOCATION	



NOTE: Must specify light duty (L/D) or heavy duty (H/D).

BALL LOCK SERIES	QTY	D	L	B	P	W	MATL.	L/D or H/D	SEAT LOCATION	