

Precision Die Sets



Contact Anchor Lamina for quoting and ordering information.

Anchor Lamina Precision Die Sets

Let us quote your precision plain-bearing or ball-bearing die sets.

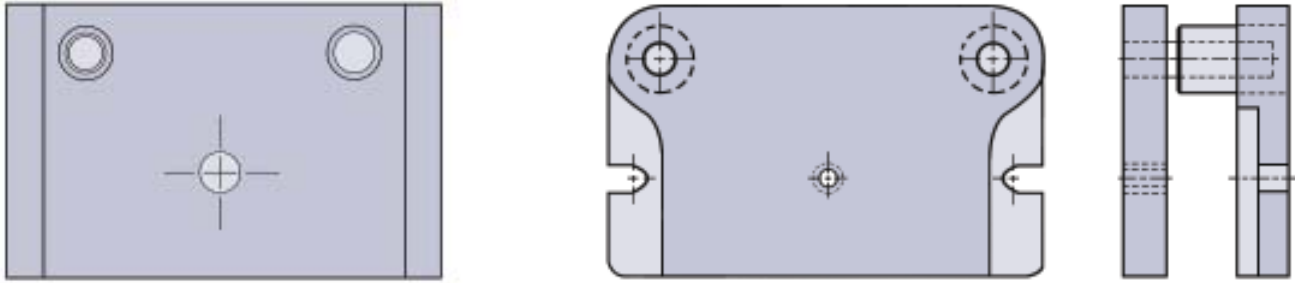

EXAMPLES

Anchor Lamina will hold the following tolerances for you:

- Punch Holder and Die Holder parallel within .0005
- Die set assembly Left to Right, Front to Rear, parallel within .001
- Location of Pins and Bushings within .0005
- Plates upper and lower ground to .0003



At this time, we will manufacture precision die sets in 2-post, center-post and 4-post styles to your specifications.

www.anchorlamina.com

**Windsor, ON,
Canada**

**CALL: 519-966-4431
800-265-5007**

FAX: 519-966-3594

**Cambridge, ON,
Canada**

**CALL: 519-740-3060
800-265-7842**

FAX: 519-740-8213

**Montreal, QC,
Canada**

**CALL: 514-525-5560
800-263-5560**

FAX: 514-525-7835

**Detroit, MI
USA**

**CALL: 248-547-5910
800-543-3790**

**FAX: 248-547-5918
800-963-0400**

**Kentwood, MI
USA**

**CALL: 616-949-8700
888-526-2467**

FAX: 616-949-9580

